

BIGBLUE UTENSIL RAIL

RCB900URSTSS

Bb

FIXING TO A STUD/BRICK WALL

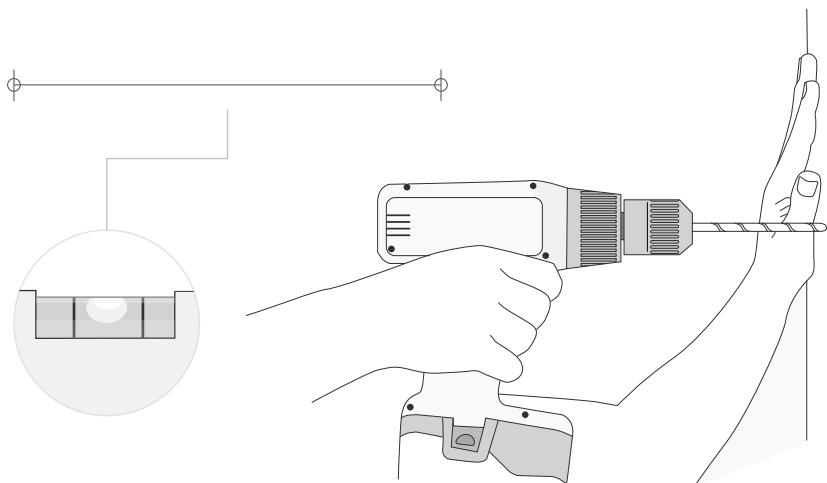

Mark two suitably spaced holes onto the surface you wish to drill, making sure they are level. Drill holes appropriate to the fixings used [see below].

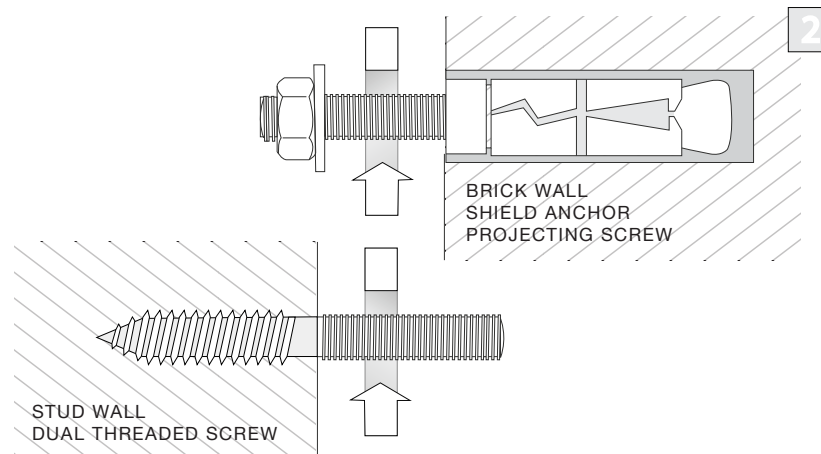

You will need the appropriate fixing, depending whether you are fixing to a stud wall or a brick wall. We recommend an M6 shield anchor projecting screw for a brick wall and an M6 dual threaded screw for a stud wall or when fixing into wood. Both are available separately from your local DIY store.

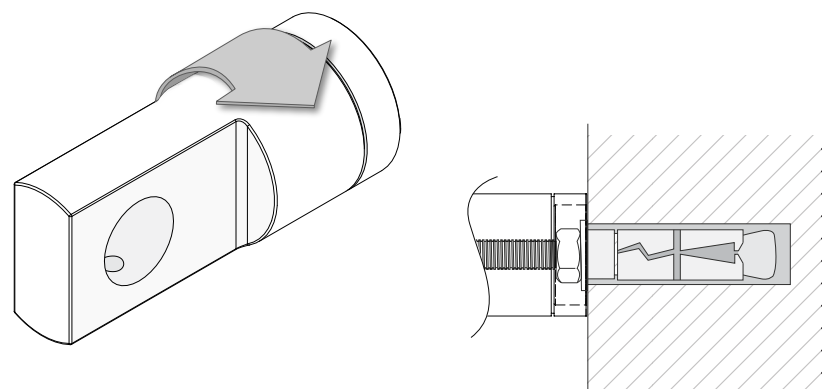

Carefully screw the boss onto your chosen fixing point ensuring that the boss is secure and the branding is positioned in the upright position. Be careful not to over tighten the boss.

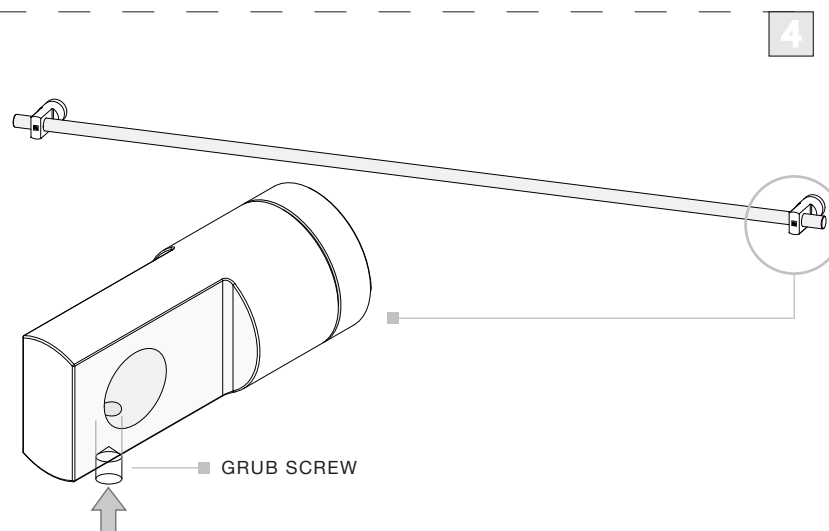

Slide the bar through the bosses, making sure that there is an even amount of bar either side. Affix the bar with the grub screws provided, making sure they are tightly secured.

BIGBLUE UTENSIL RAIL

RCB900URSTSS

Bb

FIXING TO A SPLASHBACK

What's in the box?

You should have the following;

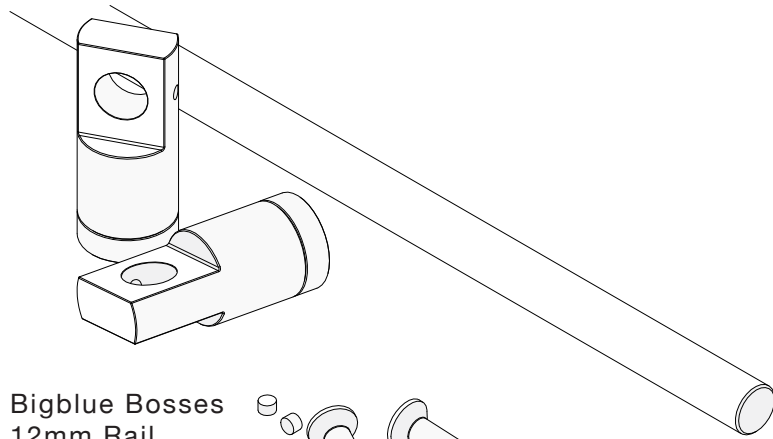

2x Bigblue Bosses
1x 12mm Rail
2x Grub screws
2x 6mm Machine screws
1x Allen Key

1

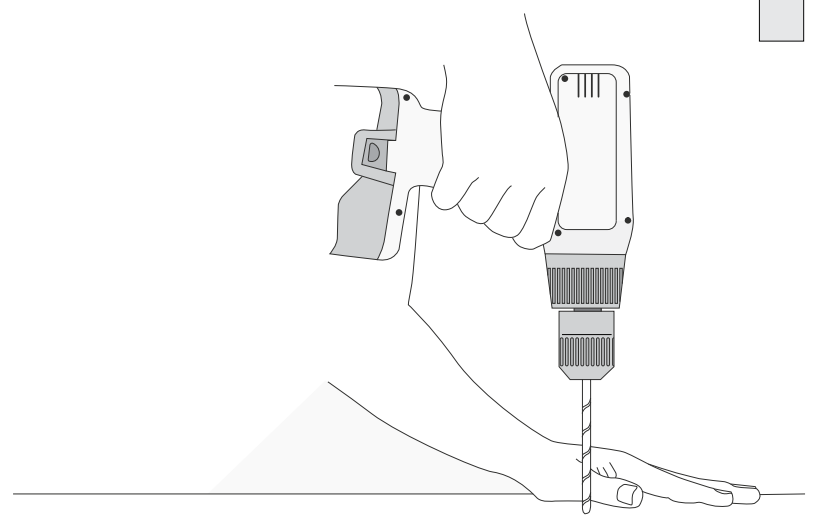

If the splashback does not already have holes, mark and centre punch two suitably spaced hole positions on the front of the panel ensuring they are level and at a practical height. Pilot drill using a 3mm drill-bit, then carefully enlarge the holes using a 7mm drill bit.

3

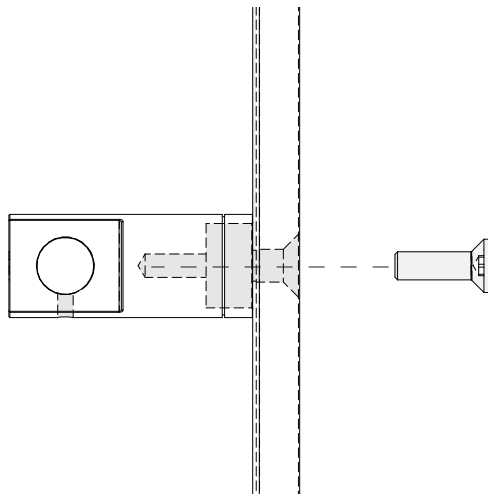

Using the M6 Screw provided, hold the boss in place [making sure the branding is in the upright position] and affix from the rear of the splashback making sure the screw head is flush below the rear surface.

4

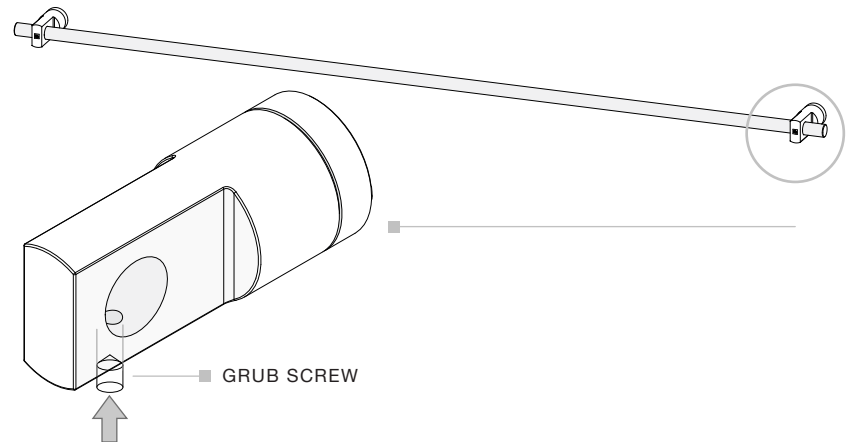

Slide the bar through the bosses making sure that there is an even amount of bar either side. Affix the bar with the grub screws provided, making sure they are tightly secured.